

MACHINED REELS

(BPS, BPE, BFP, BTC)

Partially or fully machined reels generally used for internal process. Depending on the model and the specific application, they can be dynamically balanced according to G16 ISO1940 for high process speed and can be manufactured with very high sheet thicknesses in order to increase considerably the loading capacity.



MACHINED REELS /

Double flange pressed steel reel for internal process and/or shipping, available with dimensions according to DIN standards (46395/46397) or as per customer requirements. Manufactured from high quality materials, this type of reel is provided with machined barrel and rim of the flanges suitable for lifting by means of hooks. It is dynamically balanced according to G16 ISO 1940 for process speeds up to 50 m/s and is also suitable for heavy-duty applications. It is suitable for wires and copper / aluminum cables, for rod-breakdown machines, for drawing, stranding (single/double twist), braiding, armoring, static and dynamic coilers. It is also suitable for extrusion and annealing (after drilling for the circulation of heat).

BPS



MACHINED REELS / BPS

MAIN FEATURES

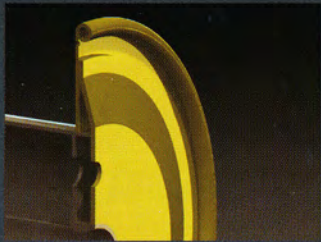

Double pressed flange

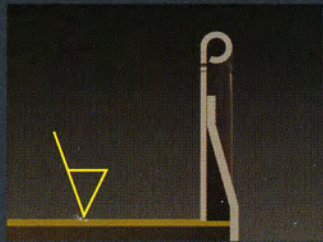

Machining of the barrel

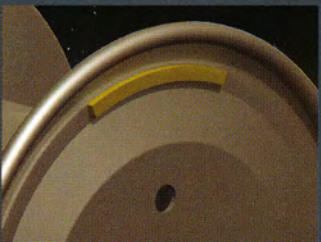

Dynamic balancing as per G16 ISO 1940 for process speed up to 50 m/s

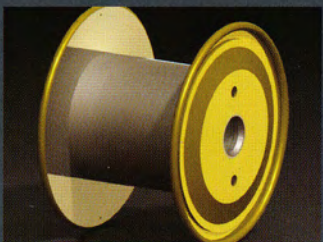

Epoxy-painting on the external surface of the flanges (all RAL colors available)

MAIN OPTIONS

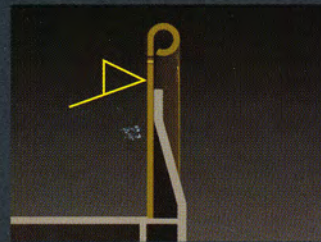

Machining of the internal side of the flanges to reduce the wobble with respect to the reel axis

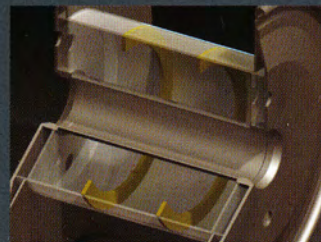

Reinforced barrel to increase the reel capacity

DRAWING TECHNICAL DRAWING TECHNICAL DRAWING

BPS reels can be manufactured with flange diameter 500, 560, 630, 800, 1000 mm and other dimensions as per DIN 46397-11: 2005-07 and DIN 46395. Flange diameter 760 mm (not included in DIN standards) and other dimensions according to special requirements are also available.

FORM "A"

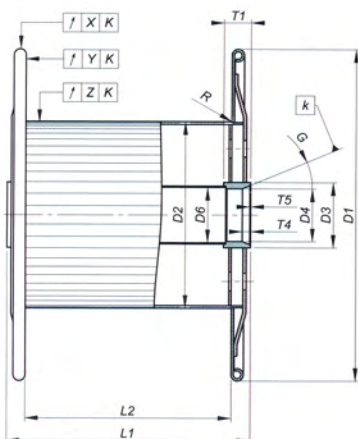

MACHINED REELS /

Solid flange reel for internal process, with dimensions as per DIN standards (46395/46397) or customer requirements. It is fully machined and dynamically balanced according to G16 ISO 1940 for process speed up to 60 m/s and it is suitable for heavy-duty applications. It is suitable for single or multi-wire drawing of copper, aluminum or ferrous wires, and can also be used in annealing, stranding, bunching and braiding processes at very high process speeds. The standard model is epoxy-painted on the external side of the flanges, but other finishing treatments are available according to the customer specification.

BPE



MACHINED REELS / BPE

MAIN FEATURES



Solid flange and high-thickness barrel to ensure high capacity

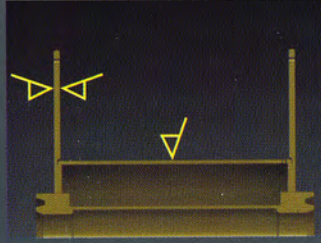

Machining of all surfaces

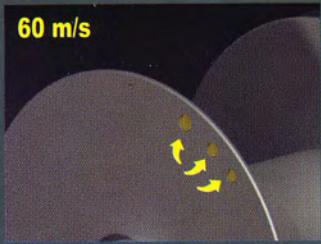

Dynamic balancing as per G16 ISO 1940 for process speed up to 60 m/s

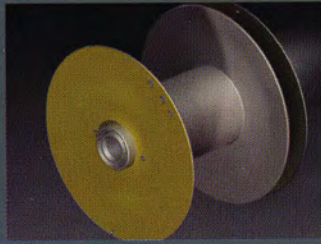

Epoxy-painting on the external surface of the flanges (all RAL colors available)

MAIN OPTIONS

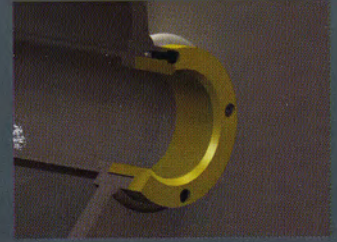

Arbor provided with interchangeable screwed bushings

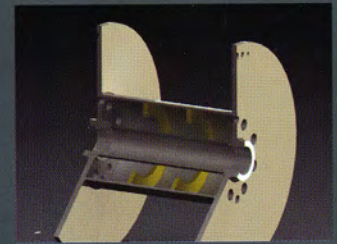

Reinforced barrel to increase the reel capacity

TECHNICAL DRAWING TECHNICAL DRAWING

BPE reels can be manufactured with a minimum flange diameter of 200 mm up to a maximum diameter of 1000 mm, and dimensions as per DIN 46397-11: 2005-07 and DIN 46395. Flange diameter 600 and 760 mm, and other dimensions according to specific requirements (in mm and inches) are also available.

FORM "A"

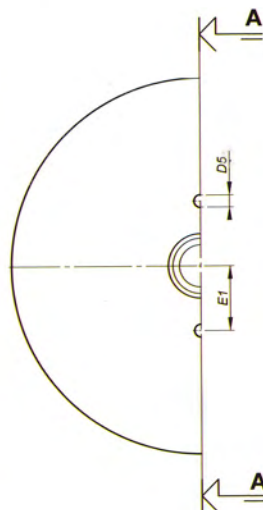
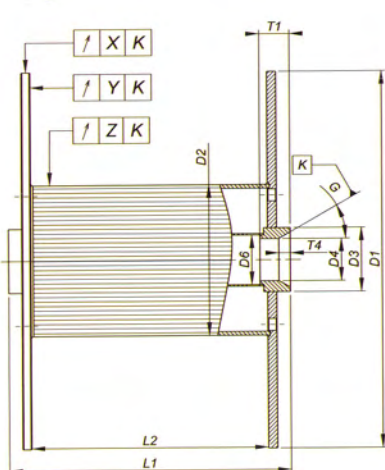

FORM "B"

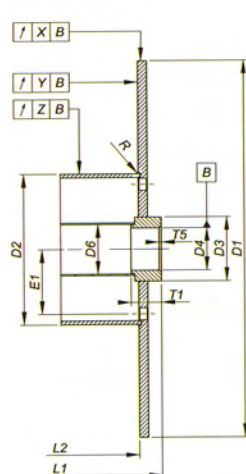

FORM "C"

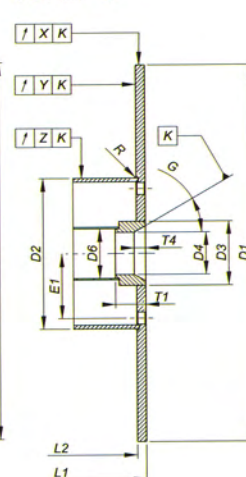

FORM "D"

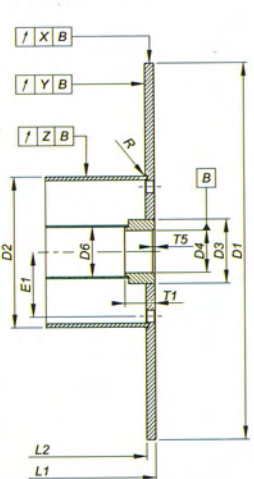

MACHINED REELS /

Structural reel suitable for internal process and manufactured with dimensions according to DIN standards (46395/46397) or to customer requirements. This type of reel is provided with solid flanges and it is suitable for the winding of cables, ropes and ferrous / non ferrous wires. It can be used in drawing, stranding, armoring and annealing processes at low process speed. This reel is available with flange diameters from 200 to 1250 mm. Within this range, all dimensions are available according to the specific request (dimensions in mm and inches). The standard model is epoxy-painted on all the surfaces, but other finishing treatments are available according to the customer specification.

BFP



MACHINED REELS / BFP

MAIN FEATURES



Solid flange and high-thickness barrel to ensure high capacity

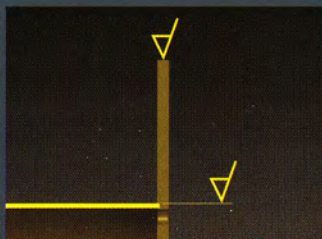

Machining of the couplings between the flanges and the barrel and machining of the outer edge of the flanges

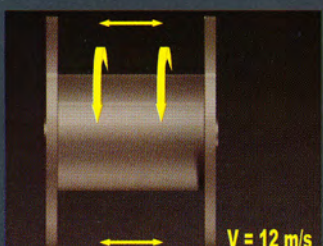

Static balancing for process speed up to 15 m/s

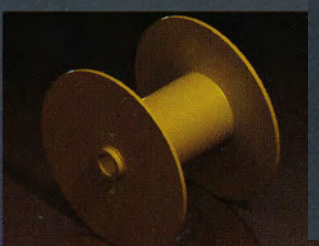

Epoxy-painting on the external surface of the flanges (all RAL colors available)

MAIN OPTIONS

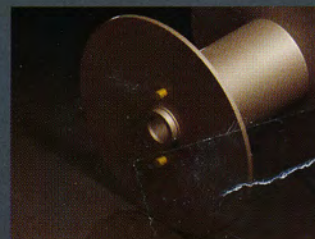

Machined pins for special driving systems

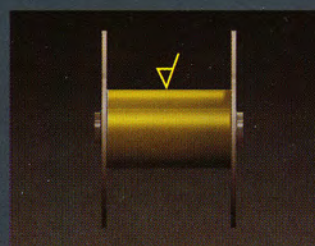

Machining of the barrel to improve the values of eccentricity of the barrel with respect to the reel axis during rotation

TECHNICAL DRAWING TECHNICAL DRAWING

BFP reels can be manufactured with a minimum flange diameter of 200 mm up to a maximum diameter of 1250 mm, and dimensions as per DIN 46397-11: 2005-07 and DIN 46395. Flange diameter 600 and 760 mm, and other dimensions according to specific requirements (in mm and inches) are also available.

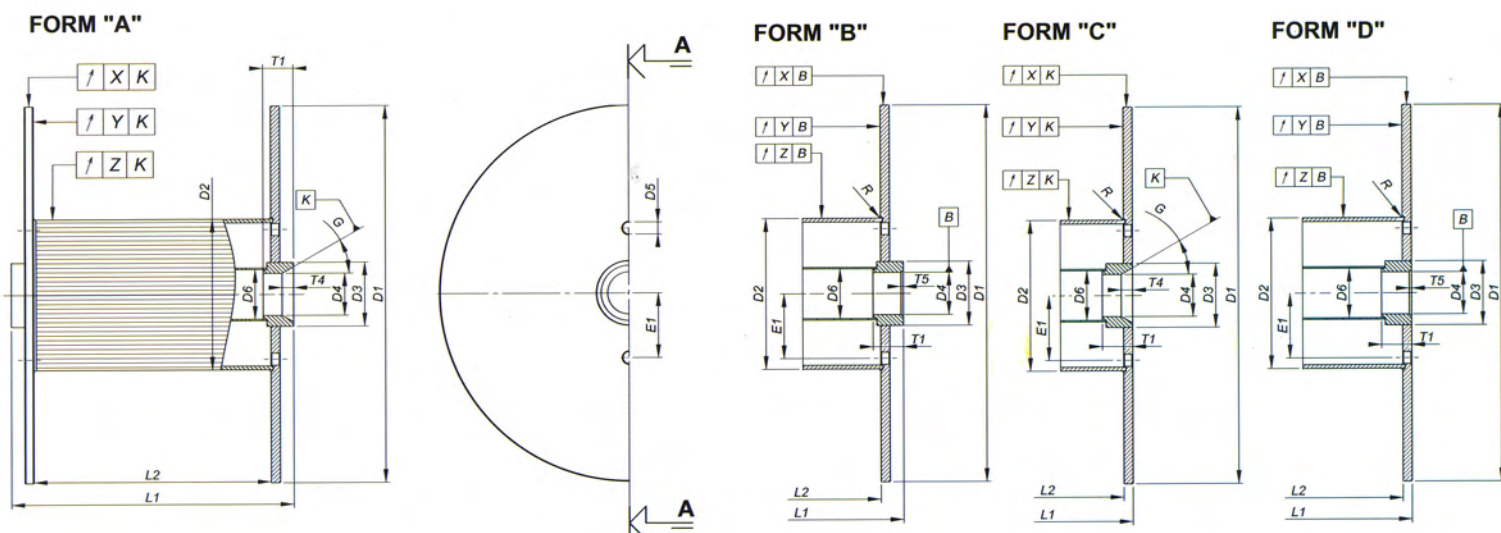

MACHINED REELS /

Heavy-duty process reel with dimensions according to DIN standards (46395/46397) or to customer requirements. The standard version is provided with double flanges reinforced by internal profiles and with high-thickness machined barrel. It is suitable for drawing processes at medium/high speed of ferrous and non ferrous wires, such as steel strips, welding wire, stainless steel wire and copper strips. It can be manufactured with appropriate reinforcements and drillings for the heat circulation, which make it suitable for annealing processes. BTC reel is provided with a robust structure and can be reinforced in the points which are more stressed by the pressure of the wound wire. The barrel and the external rim of the flanges are machined to obtain good values of eccentricity of the barrel and of the flanges with respect to the rotation axis of the reel. The standard model is epoxy-painted on the external side of the flanges.

BTC



MACHINED REELS / BTC

MAIN FEATURES

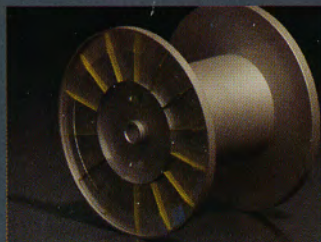

Single or double-wall flange provided with radial reinforcements

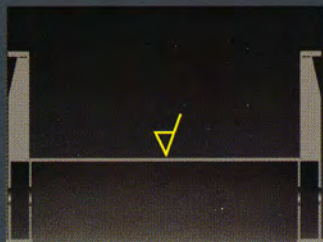

High-thickness machined barrel



Arbor provided with machined bushings

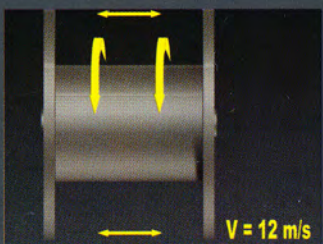

Static balancing for process speed up to 12 m/s

MAIN OPTIONS



Arbor provided with interchangeable screwed bushings



Dynamic balancing as per G16 ISO 1940 for process speed up to 30 m/s

TECHNICAL DRAWING TECHNICAL DRAWING

BTC reels can be manufactured with flange diameter 800, 1000, 1250 mm and dimensions as per DIN 46397-11: 2005-07 and DIN 46395. Flange diameter 760 mm (not included in DIN standards) and other intermediate sizes up to maximum 1250 mm are also available upon specific request.

FORM "A"

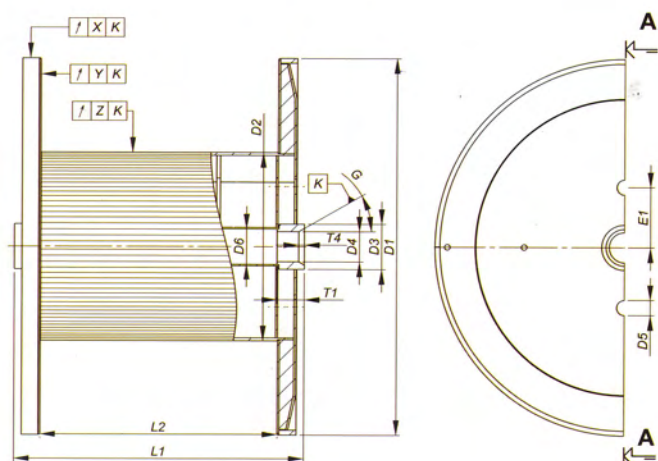

FORM "B"

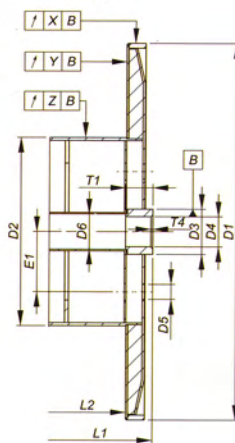

FORM "C"

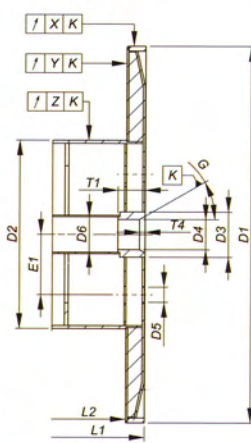

FORM "D"

