

# TAKE-APART REELS

## (BSC)

Take-apart reels for coils with collapsible barrel or suitable for use with self-supporting cardboard. They are available with mechanical, pneumatic or hydraulic opening system and can be designed with the possibility of raising the coil after the opening of the reel.

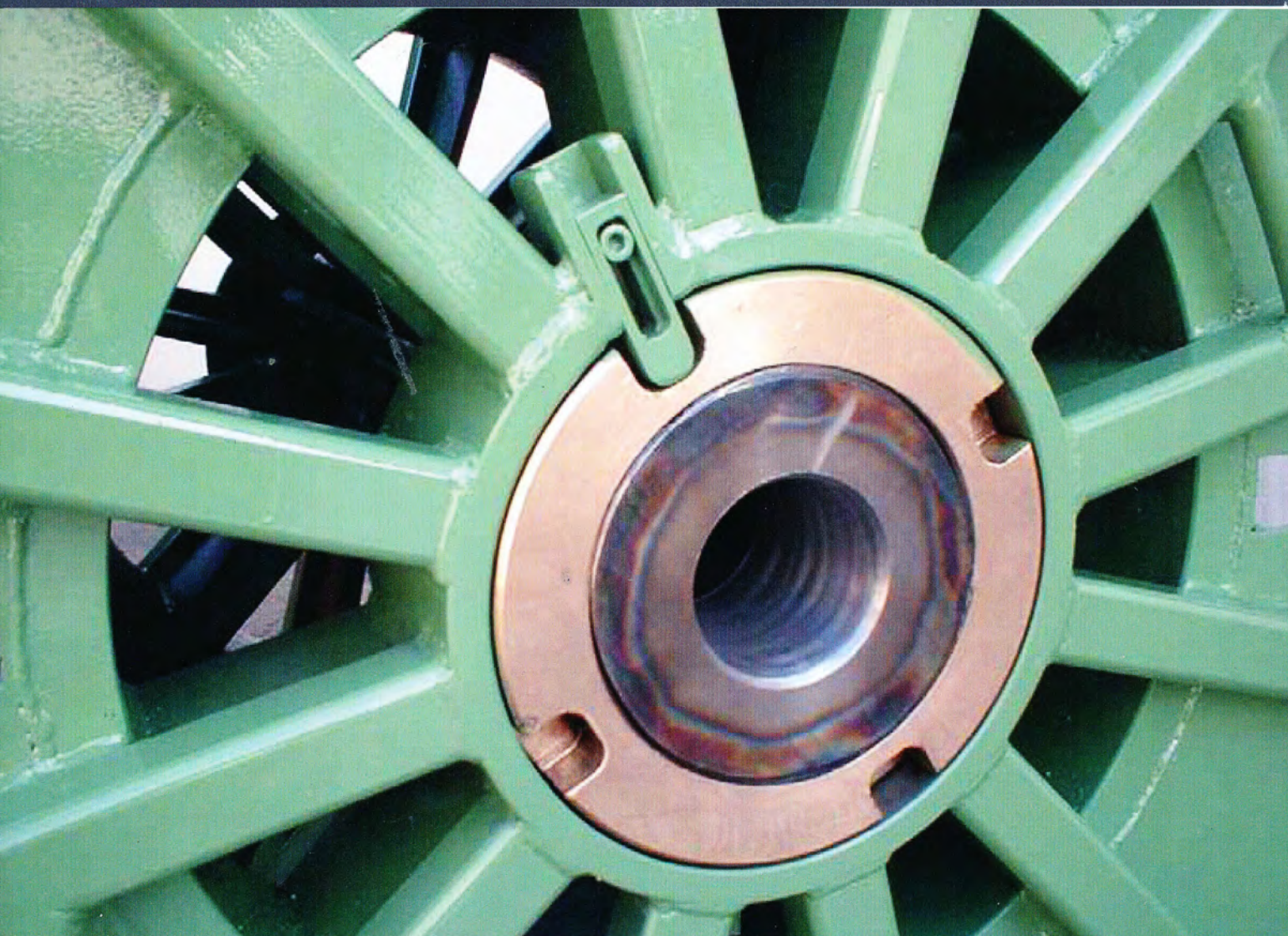



## TAKE-APART REELS /

Take-apart reels with mechanical release for the winding of coils, provided with collapsible or conical barrel or suitable for use with self-supporting cardboard. They are generally used in high speed wire drawing processes and are usually manufactured with automatic opening system, but they are also available with pneumatic and hydraulic activation. The mechanical release can be carried out by 3, 4 or more groups made up of special hardened steel threaded rods and bushings, and provided with thrust bearing. Alternatively, opening mechanical systems with central ring having passing hole, or with central screw and blank hole are also available. Depending on the specific application, BSC reels can be provided with collapsible barrel or predisposition for the housing of self-supporting cardboard. The collapsible barrel is composed of a variable number of sectors (usually 4 or 6) and is provided with special guides for the passage of straps.

# BSC





# TAKE-APART REELS / BSC

## MAIN FEATURES

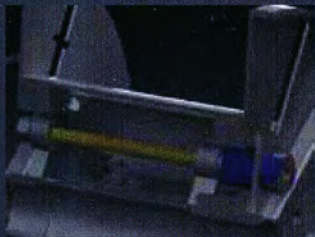

Mechanical opening system made up of hardened steel threaded rods and bushings. An opening system with central ring or screw is also available



Barrel composed by collapsible sectors to allow the removal of the coil

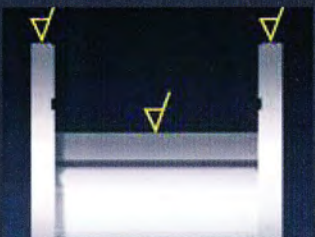

Machining of the barrel and of the external flange rim

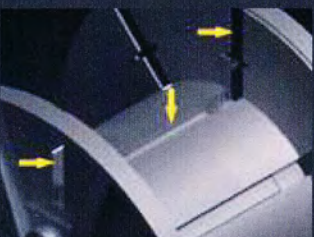

Barrel and flanges provided with guides for the passage of straps (The number of straps can vary according to the type of reel)

## MAIN OPTIONS



Prearrangement for the housing of self-supporting cardboard



Dynamic balancing as per G16 ISO 1940 for process speed up 40 m/s

## TECHNICAL DRAWING TECHNICAL DRAWING

BSC reels can be manufactured with dimensions as per DIN 46397-11: 2005-07 and DIN 46395 or according to Z2, Z3 or Z4 standards. Available flange diameters are 760, 800, 1000, 1100 and 1250 mm or other non-standard diameters upon specific request

FORM "A"

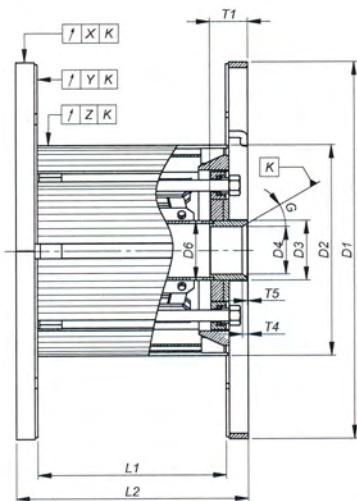

FORM "B"

